

FRANCIS ANTHONY

THE LITTLE GOURMET®
POINT-OF-USE DRINKING FAUCETS

INSTALLATION SHEET

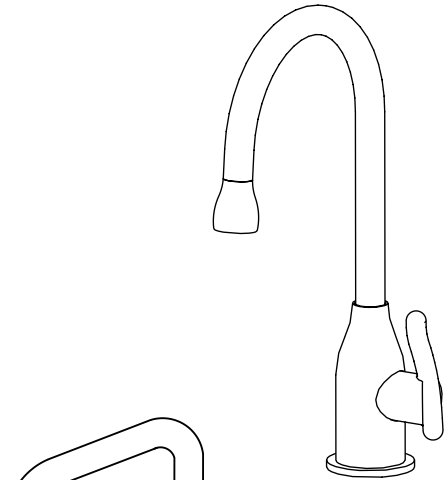

MT1803-NL

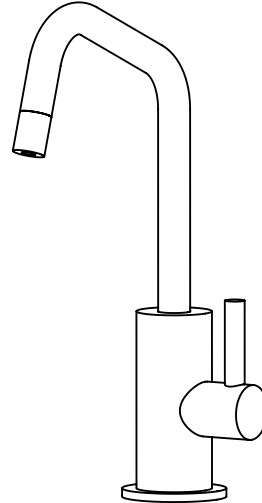

MT1823-NL

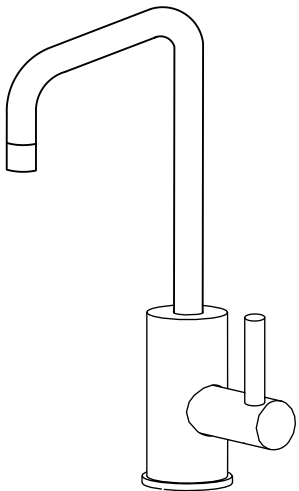

MT1833-NL

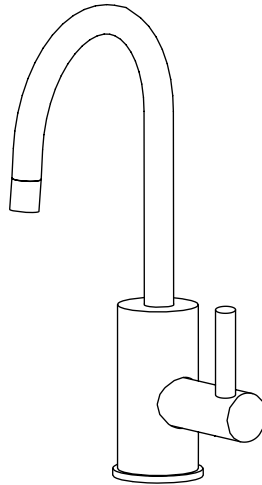

MT1843-NL
MT1843/SS

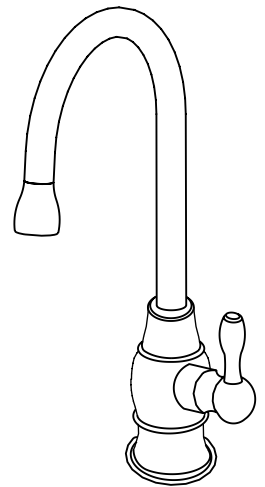

MT1853-NL

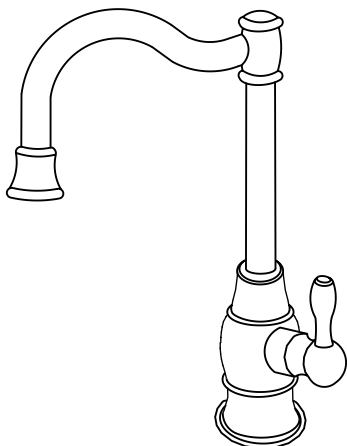

MT1873-NL

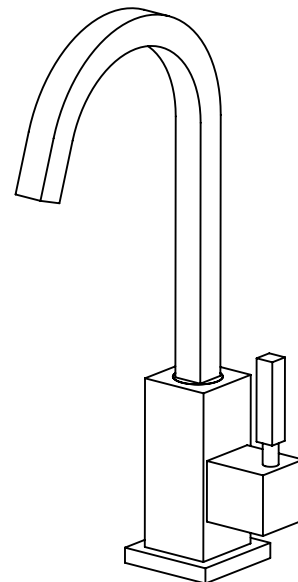

MT1883-NL

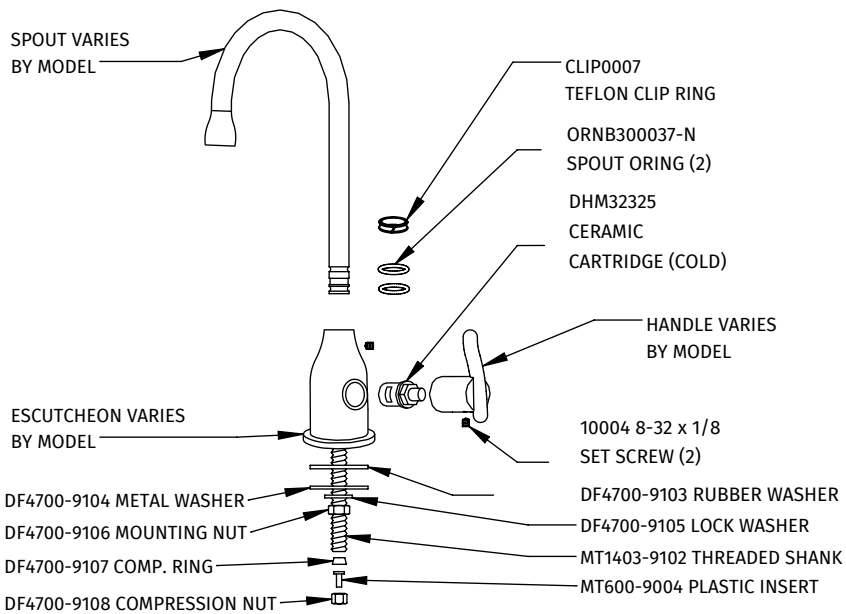

INSTALLATION INSTRUCTIONS

1. MAKE SURE COUNTER HAS A 3/4" TO 1 3/8" MOUNTING HOLE AND IS NO MORE THAN 2 1/4" THICK.
2. MAKE SURE THE ORING IS THE BOTTOM OF THE ESCUTCHEON.
3. PLACE ESCUTCHEON ON COUNTER.
4. PLACE FAUCET ON THE ESCUTCHEON.
5. FROM BELOW, SLIDE THE RUBBER WASHER & METAL WASHER ONTO THE THREADED SHANK.
6. SLIDE THE LOCK WASHER ONTO THE THREADED SHANK AND SCREW ON THE MOUNTING NUT.
7. CHECK LOCATION AND TIGHTEN.
8. SLIDE COMPRESSION NUT OVER WATER INLET TUBING.
9. SLIDE COMPRESSION RING OVER TUBE.
10. PUSH INSERT INTO TUBE.
11. TIGHTEN NUT ONTO MOUNTING NIPPLE.
CAUTION - DO NOT OVER TIGHTEN .
12. TURN ON WATER AND CHECK FOR LEAKS.

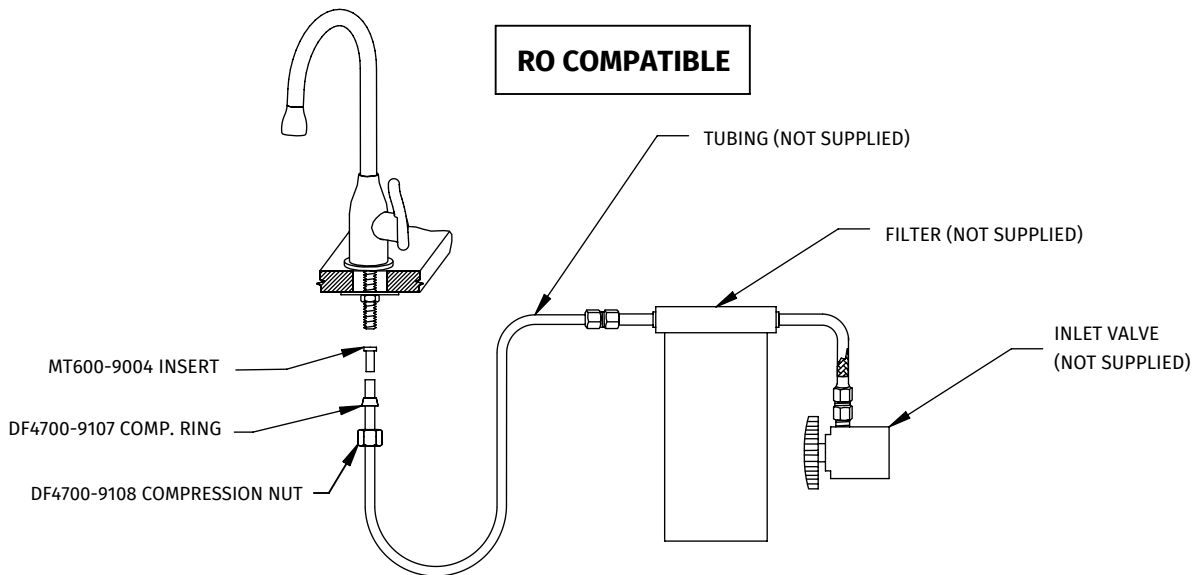

WARRANTY

FOR WARRANTY INFO PLEASE VISIT WWW.MOUNTAINPLUMBING.COM/PAGE/RESOURCES/WARRANTY

FINISH CARE & MAINTENANCE

NEVER USE ANY HARSH ALKALI, ACID BASED DETERGENTS OR CLEANERS SUCH AS SOFT SCRUB®, SCRUBBING BUBBLES® OR COMET® TO CLEAN. DO NOT USE BRILLO® OR SCOTCH BRITE® PADS. THESE WILL ALL HARM THE FINISH. TO CLEAN, USE ONLY A DAMP SOFT CLOTH AND WIPE GENTLY. STANDARD WINDEX® CAN ALSO BE USED SPARINGLY. IT IS NOT NECESSARY TO WIPE HARD TO REMOVE SPOTS. TO MAINTAIN THE FINISH, WIPE WITH A SOFT DRY CLOTH AFTER USE. AN OCCASIONAL COAT OF PURE CARNAUBA WAX WITHOUT CLEANERS WILL HELP PROTECT THE FINISH.